

# The Clam Summit Thermal & Summit Thermal FLR

## Model No.

– 8848 Summit Thermal–

– 8845 Summit Thermal FLR –

## Specifications

- Center Height - 84 inches
- Footprint - 72x96 inches
- Hub-to-Hub - 90x115 inches
- Weight – 43 lbs. (Summit Thermal)  
92 lbs. (Summit Thermal FLR)

Part Numbers:

Summit Thermal: 108848; Summit Thermal FLR: 108845

Instruction No: 103269



## - Clam Customer Service Information -

**NOTICE:** Once used, this shelter cannot be returned to the store. Please contact Customer Service directly at the email address or phone number below.

- Customer Service Hrs: 9am to 4pm, Monday – Friday Central Standard Time
- Phone: 763-231-4120
- Fax: 763-231-4121
- Email: [customerservice@clamcorp.com](mailto:customerservice@clamcorp.com)

**\*\* Warranty cannot be honored without an original, dated receipt \*\***

### IMPORTANT! PLEASE READ: Warranty Information

This product is warranted to the original retail purchaser (not transferable) its product to be free from manufacturers defects for one (1) year from the date of the original purchase. Warranty does not cover cracked windows, tent tears, broken or bent hoops due to high wind weather conditions or unattended use. The part will be replaced or repaired (manufacturer's option) if found defective within the one (1) year time frame. Warranty will be void if product has been subject to neglect, misuse, improper installation, misapplication, alteration, or accident including, but not limited to, improper maintenance or use of unauthorized parts or attachments. Please read this entire owner's manual to ensure proper installation, use, storage, and care for your Clam shelter.

**To submit a Warranty Claim Request, please use one of the following methods:**

- Email: [CustomerService@ClamCorp.com](mailto:CustomerService@ClamCorp.com) (Preferred Method)
- Call: 763-231-4120
- Write: Customer Service – Warranty Department  
600 Clydesdale Trail  
Medina, MN 55340

**Information needed to submit a warranty claim:** If you need to submit a warranty claim, please e-mail Clam's Customer Service Department at [customerservice@clamcorp.com](mailto:customerservice@clamcorp.com). In your e-mail, please include your full name, address, phone number, a copy of your receipt, a brief description of the problem, and pictures to clearly show the area(s) of concern. Clam's warranty department will review your request and a Clam representative will contact you regarding your claim status. All returns must be returned with postage pre-paid.

## - Limitation of Liability -

*It is expressly understood that Clam Corporation's liability for its products, whether due to breach of warranty, negligence, strict liability, or otherwise, is limited to the repair of the product as stated above. Clam Corporation is not liable for any injury, loss, damage, or expense, whether direct or consequential, including but not limited to loss of use, income, profit, or damage to material arising in connection with the sale, installation, use of, inability to use, or the repair or replacement of Clam Corporation products. Clam Corporation reserves the right to make alterations or modifications in its products at any time, which in its opinion, may improve the performance and efficiency of the product. Clam shall not be obligated to make such alterations or modifications to products already in service.*

## SAFETY INSTRUCTIONS

Please fully understand and follow all safety instructions outlined in this booklet. Failure to do so could result in severe injury.

- Do not use open flame heaters in your ice shelter. Open vents for cross ventilation.
- Ice Armor fabric will melt when contact is made with hot surfaces (i.e., heaters).
- Never leave shelter unattended when set up.
- Due to the increase in traffic (snowmobiles, autos, etc.) on area lakes, ice fishing can be hazardous at night. If you choose to fish at night or in poor visibility conditions, be sure to take precautions with lights or reflectors to show drivers your whereabouts.
- Use extra tie-downs during excessive wind conditions

## WARNING

Death from asphyxiation may result from use of oxygen depleting heaters. Open all vents for fresh air ventilation.

Injury or death may result from fire if tent fabric is exposed to open flame.

Tent fabric is not fireproof. Fabric will burn with extended exposure to open flame. Do not use open flame products inside tent. Tent fabric is treated with fire retardant. Application of any foreign substance may render the flame retardant properties ineffective.

Night time: exterior reflectors must be visible to reduce risk of collisions.

This tent is made with flame resistant fabric which meets CPAI-84 specifications.

## CLAM SUMMIT & SUMMIT THERMAL FLR PARTS LIST

	<u>ITEM #</u>	<u>DESCRIPTION</u>	<u>QTY.</u>	<u>PART NO.</u>
Customer service hours: 9am – 4pm, (Central Time) Monday-Friday.  customerservice@clamcorp.com	1	HUB ASSY	5	103243
	2	ICE ANCHOR	4	102457
	3	TIE DOWN ROPE	4	102458
	4	FIBERGLASS POLE-Front & Rear	8	103249
	5	FIBERGLASS POLE-Sides & Top	12	103250
	6	BUCKLE ASSY WITH STRAP	6	103244
	7	CARRY BAG	1	103259
	8	BASE ASSY WITH FEMALE STRAPS	1	108425
	9	INSTRUCTIONS/OWNER'S MANUAL	1	103269
Ice Anchors and ropes included in small carry pouch				

Replacement parts can be ordered on-line at <http://www.clamcorp.com/Resources/Parts>.

## ASSEMBLY INSTRUCTIONS

**BEFORE ATTEMPTING TO USE THIS PRODUCT ON THE ICE** practice setting up and taking down at home in the comfort of a heated area. Repeat several times until comfortable. This will make your on-ice set-up much easier.

1. Unzip the storage bag completely and remove the shelter. Use care not to misplace the anchor & rope pouch (**Photo 1**). It is advised to store your anchors, ropes, and pouch in the storage pocket of your carry bag.

Anchor & rope pouch

Photo 1

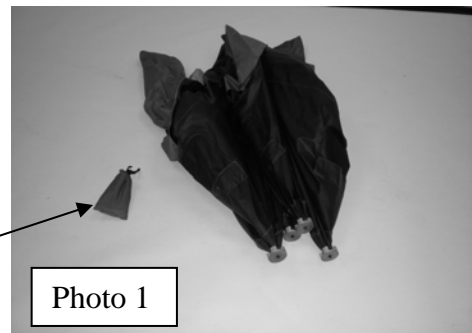

# ASSEMBLY INSTRUCTIONS

2. Open the shelter so that the gray top is facing upward. Lay the shelter as flat on the ice as you can, making sure that the tent is not twisted or overlapping any of the poles **(Photo 2)**. Do NOT force the shelter while unfolding.



3. Stand on the skirt of the long side of the shelter, grasp the loop sewn onto the eyelet in the center of the roof with one hand, and place your other hand on the opposite side at the roof line. Pull upward on the loop while pushing on the roof line until the roof section pops up. **(Photo 3)**.



4. Once the roof is popped up, go to one of the short (6 foot) sides of the shelter. Step on the skirt, feet wide **(Photo 4)**, grab the top corners on both sides and pull straight up **(Photo 5 & 6)**. Once the wall is up, grasp the loop sewn onto the eyelet in the center of the short side wall and pull outward until the wall pops up **(Photo 7)**.

Repeat this procedure for all the walls, going around the shelter either clockwise or counter-clockwise **(Photo 8)**.

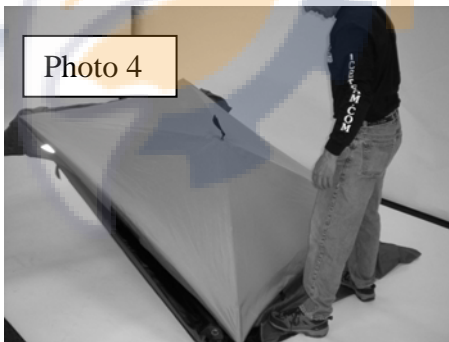

## ASSEMBLY INSTRUCTIONS

5. Your shelter should be standing up completely (**Photo 9**). Anchor the shelter to the ice by using ice anchors and ropes (Summit models). For Summit Thermal FLR models, skip to page 5.

Screw ice anchors into the ice near the corners of the shelter using Clam's Ice Anchor Installation Tool PN 108348 (not included). Feed the adjustable strap grommet onto the ice anchor and cinch the strap tight (**Photo 10**). Repeat for each anchor drilled into the ice. In windy conditions you may need to screw an anchor outside the shelter several feet away from the hub on the windward side and attach a rope from the hub eye bolt to the remote anchor. This will help keep the shelter in place and the walls from collapsing. If more anchors are needed, order PN 102457 via [www.clamcorp.com/resources/parts](http://www.clamcorp.com/resources/parts).



Photo 10



Ice Anchors in corners. Shelter is secured to the ice by hooking the grommet on the strap to the anchor and cinching the strap tight.



## ASSEMBLY INSTRUCTIONS-FLR MODEL

When assembling your Summit Thermal FLR, bolt the female buckles to the base in the positions shown. Insert the bolt through the bottom of the base, place the grommeted hole from the buckle strap onto the bolt, add the washer and the nut and tighten with a 7/16" wrench and Phillips screwdriver.

Place female buckles with short straps here.

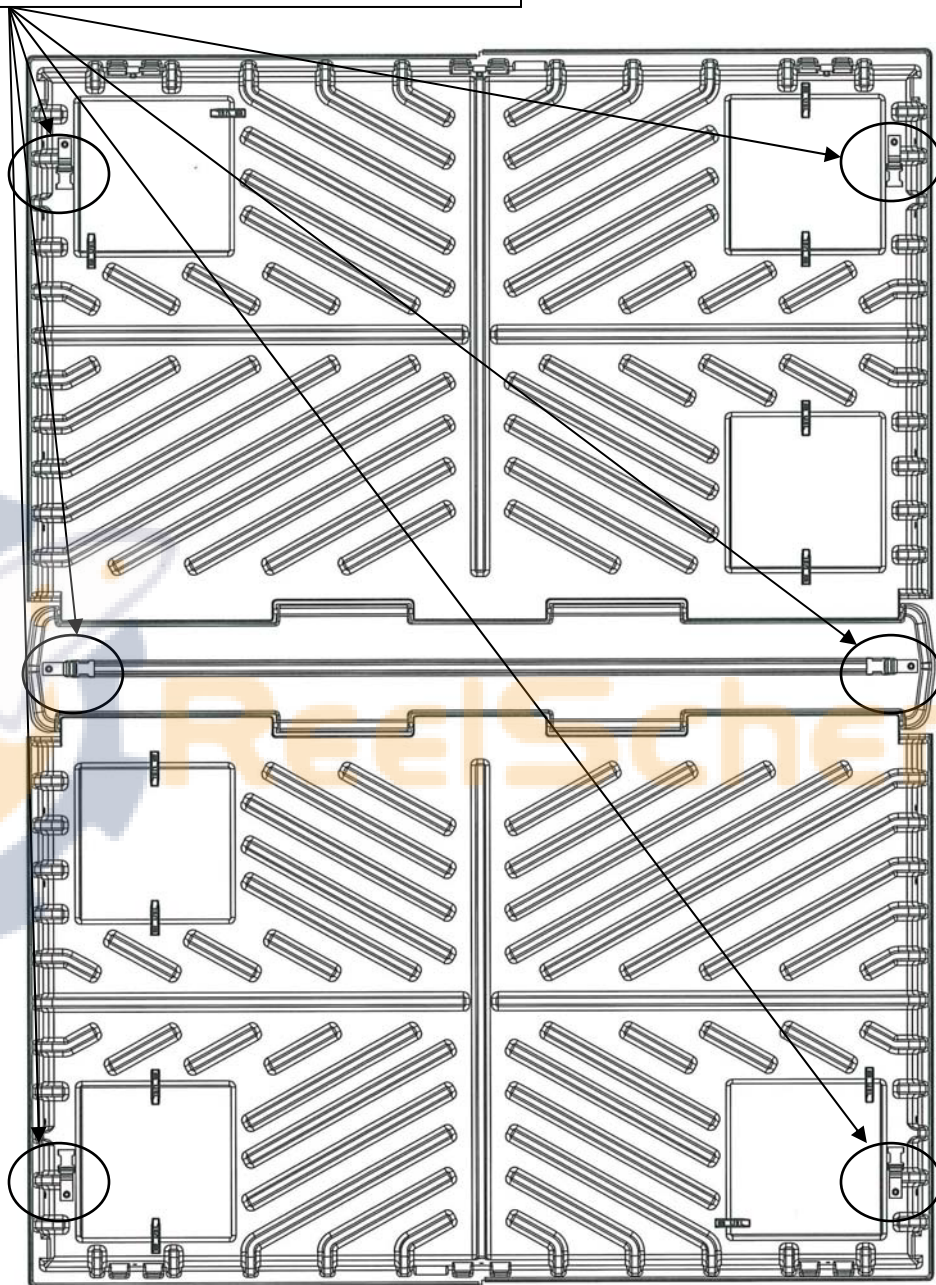

Correctly Assembled



# ASSEMBLY INSTRUCTIONS

6. For FLR (floor) models, open the plastic base and place the shelter in the base (**Photo 11**). All four corners of the shelter fit inside of the base (**Photo 12**).

Attach the six buckles affixed to the inside of the shelter to the buckles attached to the base floor (**Photo 13**).

In windy weather, anchoring one or more side hubs to ice anchors mounted in the ice several feet from the shelter may be needed.



Photo 11



Photo 12

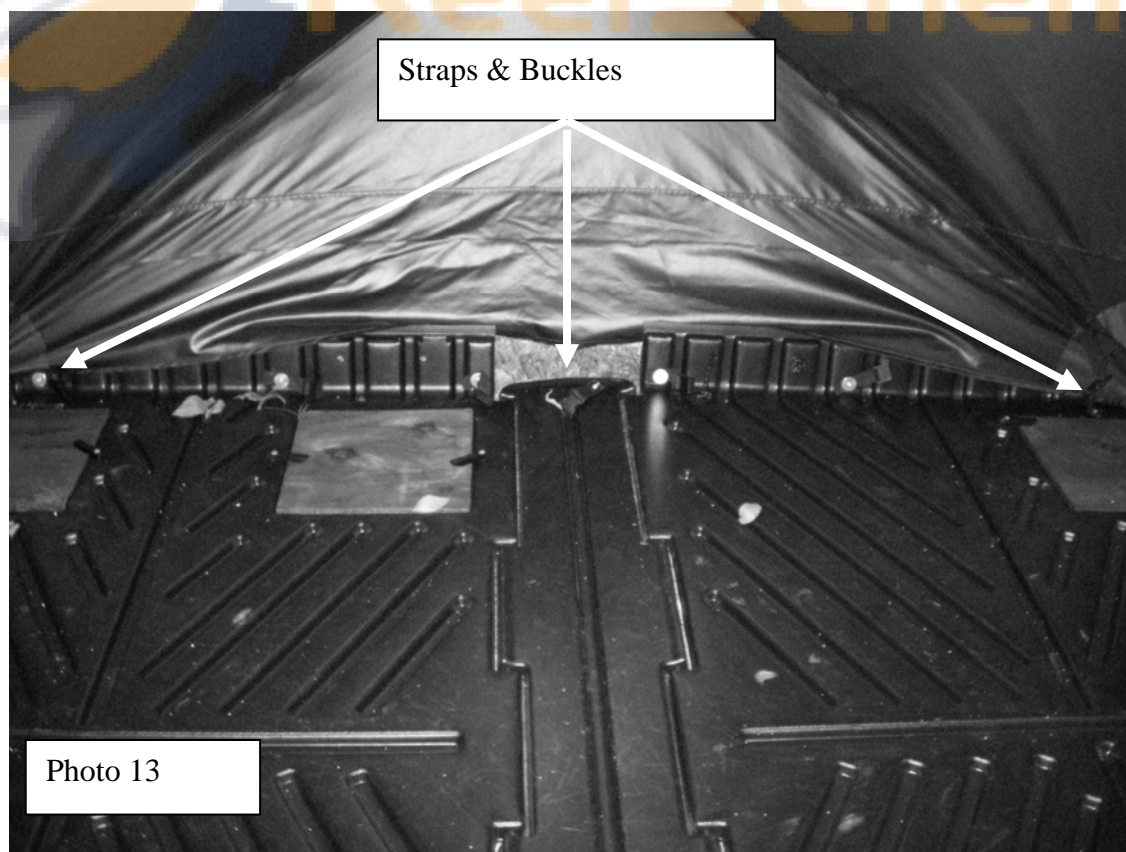

Straps & Buckles

Photo 13

# TAKE-DOWN INSTRUCTIONS

## TAKE-DOWN INSTRUCTIONS

1. Close all windows. Leave one or both doors open to allow air to escape.
2. Remove all ropes and ice anchors and store them in the provided pouch or in the carry bag side pocket. In windy conditions, remove ice anchors after collapsing the roof and walls.
3. Step on the skirt of the short (6 foot) side. Push the center hub until the wall collapses inward (**Photo 14**). Continue either clockwise or counter-clockwise pushing each wall inward until all the walls are collapsed (**Photo 15**). The shelter will fall to the ice on its own.
4. Push the hub of the roof down until it collapses (**Photo 16**).

**NOTE:** Make sure the roof collapses all the way. You may have to pull up on the edge of the roof to get the roof hub to collapse.

5. Unclip the shelter from the base on FLR models. Fold up the shelter (**Photo 17**).

6. When folding the Summit up for storage, inspect the hub systems and poles for entanglement.

**NOTE:** It is extremely important to ensure the hub systems and poles are not tangled before completely folding the tent up for storage (**Photo 18**).

7. Once the hub systems are all free and the tent is completely folded, store in carry bag. Place the folded shelter and the ice anchor/rope pouch back into the carrying case with the hubs toward the bottom end of the bag.

8. For Summit FLR models, simply place the folded shelter and ice anchor/rope pouch inside of the base and close the base (**Photo 19**).

***Make sure your ice shelter is completely dried out after each use and before storing. Store your ice shelter in a cool, dry place. Keep away from rodents.***

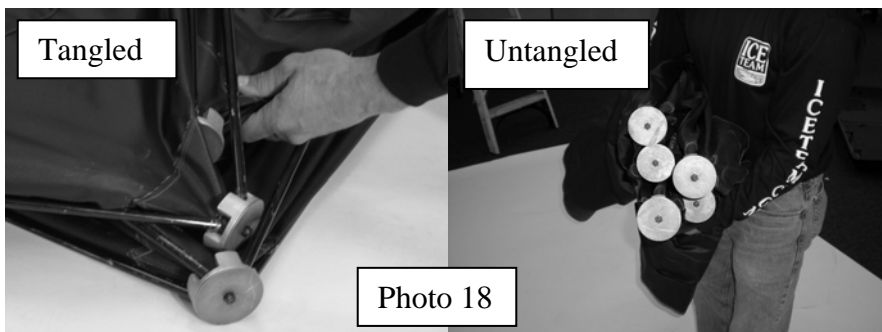



## - Safety Instructions -

*Please fully understand and follow all safety instructions as outlined. Failure to do so could result in severe injury or death.*

- *Do not use open flame heaters in your ice shelter. Injury or death may result from fire if tent fabric is exposed to open flame. The tent is not fireproof, but the fabric is treated with a fire retardant that meets CPAI-84 specifications. Application of any foreign substance may render the flame retardant properties ineffective. Ice Armor fabric will melt when contact is made with hot surfaces (i.e., heaters).*
- *Death from asphyxiation may result from use of oxygen depleting heaters. Open all vents for fresh air ventilation.*
- *Never leave shelter unattended when set up.*
- *Due to the increase in traffic (snowmobiles, autos, etc.) on area lakes, ice fishing can be hazardous at night. If you choose to fish at night or in poor visibility conditions, be sure to take precautions with lights or reflectors to show drivers your whereabouts. Night time: exterior reflectors must be visible to reduce risk of collisions.*

### **WARNING**

Death from asphyxiation may result from use of oxygen depleting heaters. Open all vents for fresh air ventilation.

Injury or death may result from fire if tent fabric is exposed to open flame.

Tent fabric is not fireproof. Fabric will burn with extended exposure to open flame. Do not use open flame products inside tent. Tent fabric is treated with fire retardant. Application of any foreign substance may render the flame retardant properties ineffective.

Night time: exterior reflectors must be visible to reduce risk of collisions.

This tent is made with flame resistant fabric which meets CPAI-84 specifications.

*\*For replacement parts, frequently asked questions, shelter information, and all of your ice fishing needs visit our web site at [www.clamcorp.com](http://www.clamcorp.com).*



## FREQUENTLY ASKED QUESTIONS

Q: I can see pin holes in my fabric:

A: There are a few explanations as to why those pin holes exist.

- Simply the color and/or black-out coating being worn off the fabric due exposure in the elements and wear due to friction.
- Ice Armor fabric is a woven material and these pin holes are parts of the thread that the coating did not attach to. Either way this has no effect on the function of the fabric and is simply an appearance issue.

Q: There are cracks on the inside finish of the fabric:

A: This is normal, when you fold up your shelter, lines develop in the fabric. The inside coating may even appear to be peeling. This is normal and will not affect the overall function of the ice house.

Q: Will my Fish House leak because I can see pin holes in the fabric?

A: Quite the opposite, as you heat your house and the snow and ice begin to melt, the vapors can better escape the shelter through an uncoated fabric. When it snows or rains, the water molecules are larger than the vapor molecules and cannot pass through the fabric and into the house.

Q: Are patch kits available for my Fish Trap and Clam shelter?

A: Patch kits are available they can be purchased online [www.clamcorp.com](http://www.clamcorp.com) under “Resources” “Parts”

Q: How do I apply the patch material?

A: When applying a patch it works best to spray some adhesive (we recommend using 3M #77 or 3M #90 spray adhesive) on to both surfaces; the part of the tent where the patch is going to be applied and the patch itself. Wait until the adhesive begins to dry and becomes tacky, then place the patch on the tent, and they will stick together.

Q: Is there anything can be put on outside of the tent to prevent water from coming through, when we are using it?

A: Customers have been known to spray or apply water repellant on the outside of the shelter that you would use for camping tents or boots. (Camp Dry would be an example of this type of product). These products will not damage your tent in anyway.

Q: What will help keep mice or rodents from eating my Clam Hub?

A: Some of our customers have had success with the following ways to keep mice out.

- Keep your tent in a sealed plastic tote with DRYER SHEETS and or MOTH BALLS

Q: The zipper on my canvas freezes up and or sticks; is there anything I can use to help prevent this from happening?

A: Yes, there are a couple of zipper lubricants out there that our customers and pro staff have had good luck with.

- Zipper Lube - A gel that you can apply just by squeezing it onto the zipper and moving the zipper back and forth. This brand can be found in the camping section of most sporting goods store.
- Silicone spray may also be used as well.

Q: Would it be best to completely dry my shelter out every time it gets used?

A: It is recommended to dry your tent out completely after each use, if not dried completely moisture left in the house may cause damage to your tent.

Q: How do I wash my shelters canvas?

A: You can use a bleach and water solution (10 parts water to 1 part bleach) to get rid of the mildew smell. If you want to wash the tent you can use a standard soap to wash it.

\*\*\* Please note - We **do not** recommend placing your shelter canvas/tent into a washing machine for cleaning.

Q: Am I able to order parts and accessories from your website?

A: Absolutely, if you would like to order parts you can go to [www.clamcorp.com](http://www.clamcorp.com) under “Resources” “Parts”